



IRR25-21

Technical specifications

Intended use	Endodontics				
Indications for use	Ultrasonic irrigation				
Description	IrriSafe™ files are used to irrigate the root canal at the end of preparations				
Tip type	File				
Allergenic factor	Tip made of surgical stainless steel as per ASTM F899 - 12b				
	Chemical composition of the file holder: <ul style="list-style-type: none">• nickel• chromium				
Commercial reference	IRR25-21 : F43805				
Medical class	Class of medical device: IIa according to 93/42/EEC directive				
Adjustments	Newtron range	P5 Range	Suprasson P5 Booster	Prophy Max - P-Max - Implant Center 2 - Piezotome 2	Irrigation
	6	6	4	1	

Service life

As it is not possible to establish a maximum number of uses (that may be determined by many parameters such as duration of use, hardness of tissue, the force applied, wear), we recommend that medical devices being routinely used are replaced at least once a year. Replace the medical device if the tip does not vibrate at the expected frequency, the treatment is not progressing as normal and is taking longer or is at a standstill.

Associated documentation

Document title	References
Consulting electronic user instructions	J00007
Cleaning, disinfection and sterilisation instructions for tips	J02001
IrriSafe clinical tips	J08081
Ultrasonic generator power settings table	J58000
General instructions relating to the complete range of standard ultrasonic dental tips	J02101

Sterilisation



Sterilise prior to each use

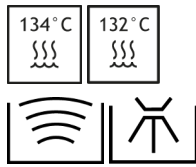

The tips must be cleaned, disinfected and sterilised prior to each use. Prior to each use, please refer to the cleaning, disinfection and sterilisation instructions for tips J02001.

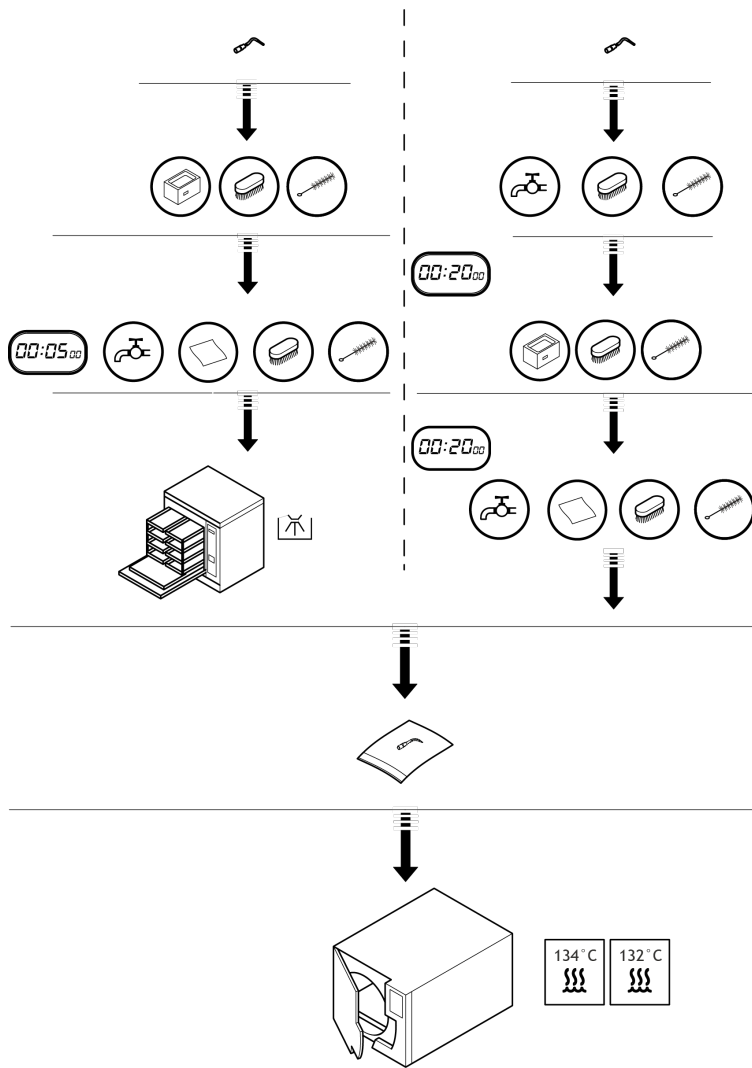

Installation

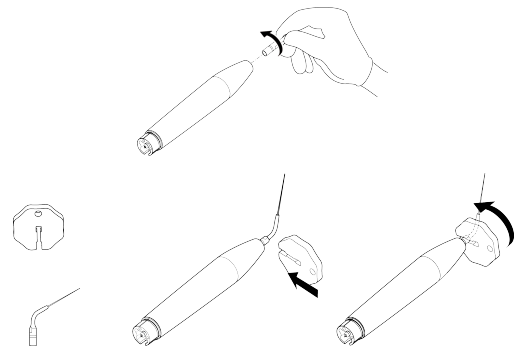

Disassembly

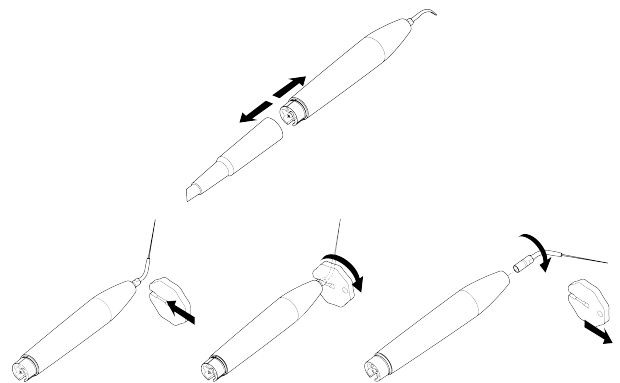

Manufacturer identification



SATELEC
 A Company of ACTEON Group
 17, avenue Gustave Eiffel
 ZI du Phare
 33700 MERIGNAC
 France
 Tel. +33 (0) 556.34.06.07
 Fax. +33 (0) 556.34.92.92
 E.mail : satelec@acteongroup.com
 www.acteongroup.com



Date of first CE marking

2007



The practitioner has to continually monitor the clinical site to immediately identify any heating risk.

File | IRR25-21 | J00911 | (07) | V4 | 09/2021 | NB25EN090D

SATELEC | A Company of ACTEON Group
 17 av. Gustave Eiffel | ZI du Phare
 33700 MERIGNAC | FRANCE
 Tel. +33 (0) 556 34 06 07 | Fax. +33 (0) 556 34 92 92
 satelec@acteongroup.com | www.acteongroup.com

Download



Instructions For Use

